

圖 (一) 臺音館_前廳空間尺寸 (單位：公分)
 Figure(1) Taiwan Music Institute _Foyer Dimension (Unit: cm)



圖 (二) 臺音館視聽室_舞台尺寸資料 (單位: 公分)
 Figure(2) Lecture Room_ Stage Dimension (Unit: cm)



圖 (三) 臺音館視聽室_觀眾席區淨空尺寸 (單位: 公分)
 Figure(3) Lecture Room_Floor Plan without Auditorium (Unit: cm)

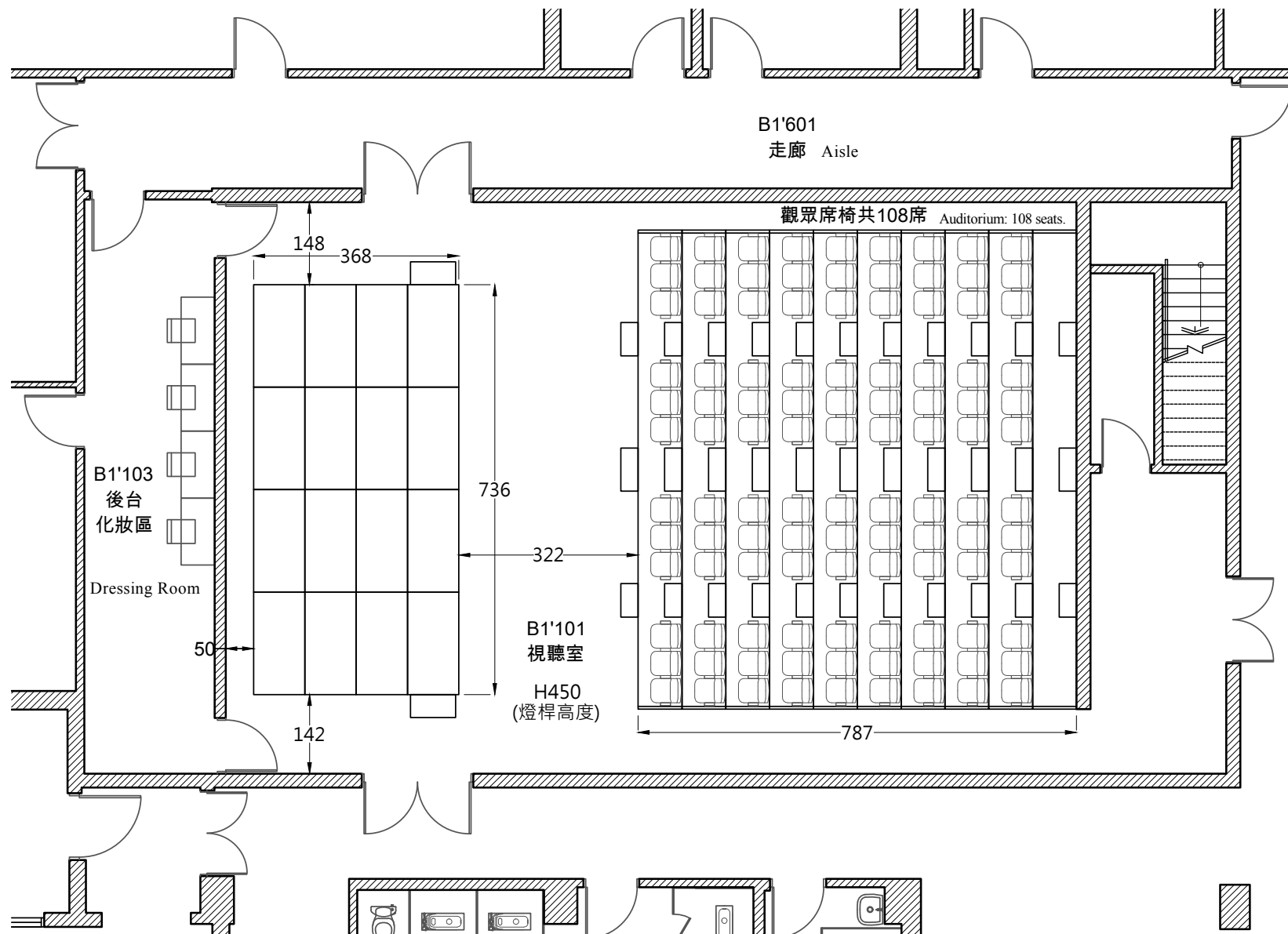

圖 (四) 臺音館視聽室_桁架尺寸資料 (單位: 公分)
Figure(4) Lecture Room _ Grid Dimension (Unit: cm)



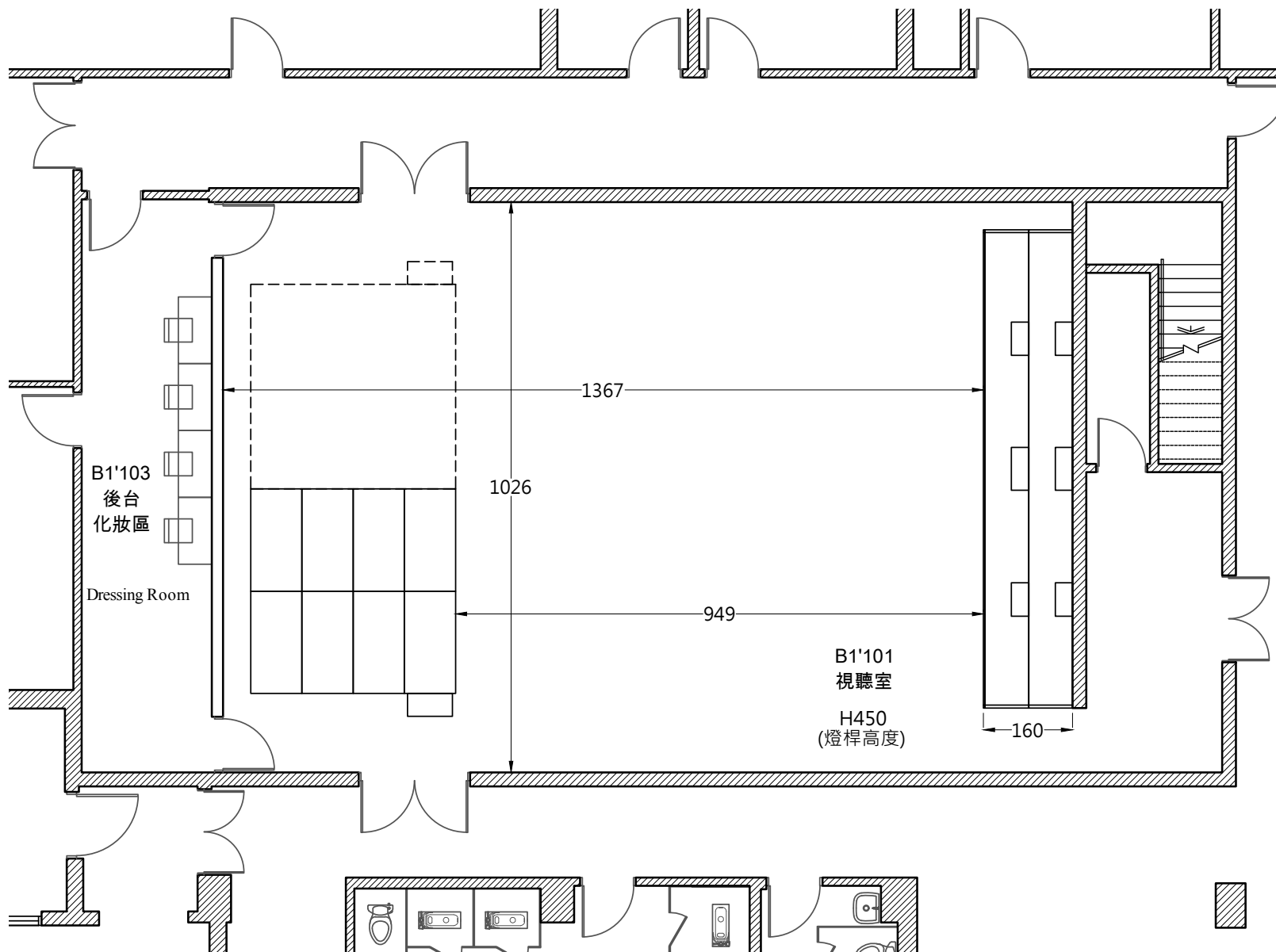

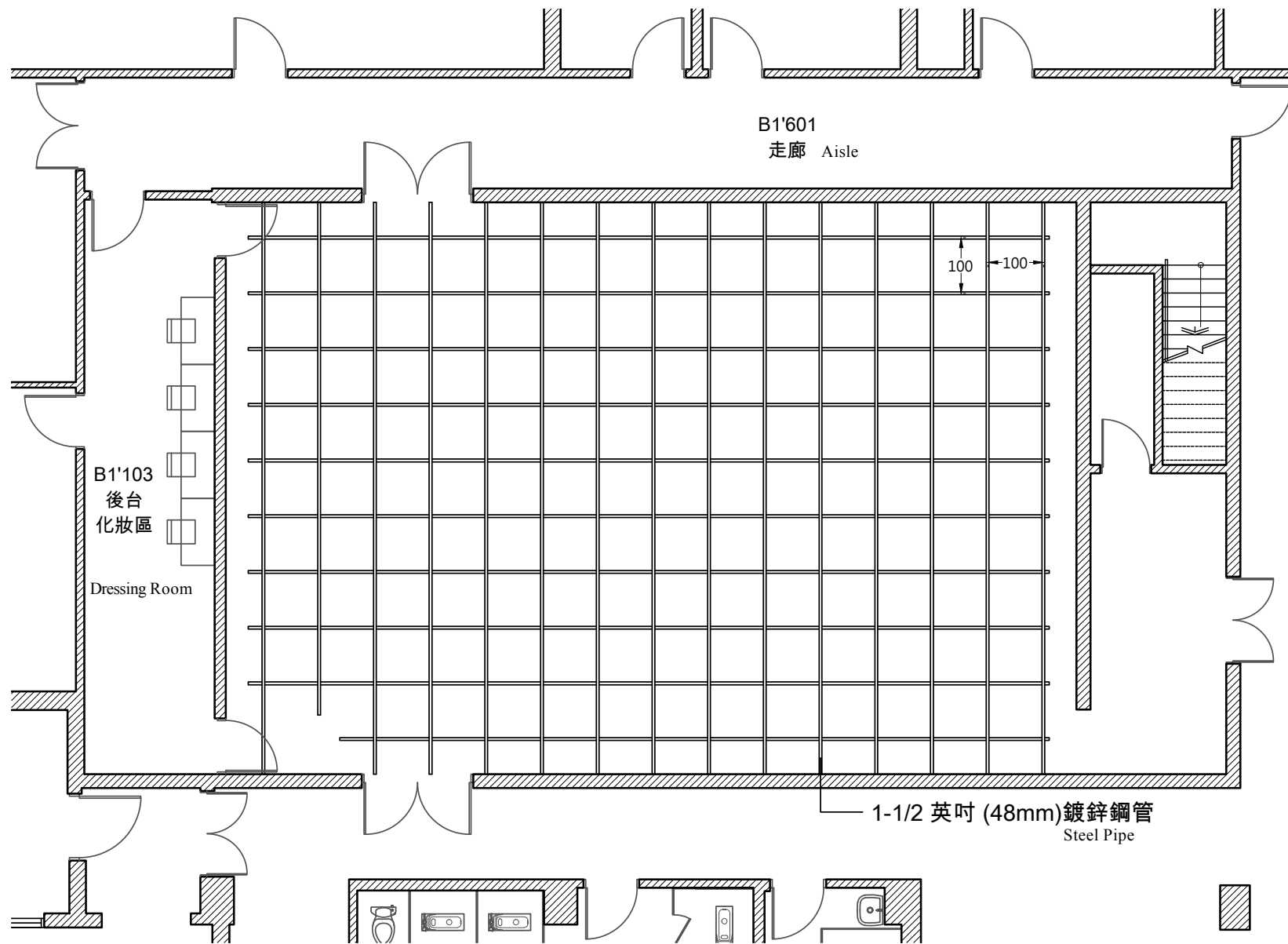
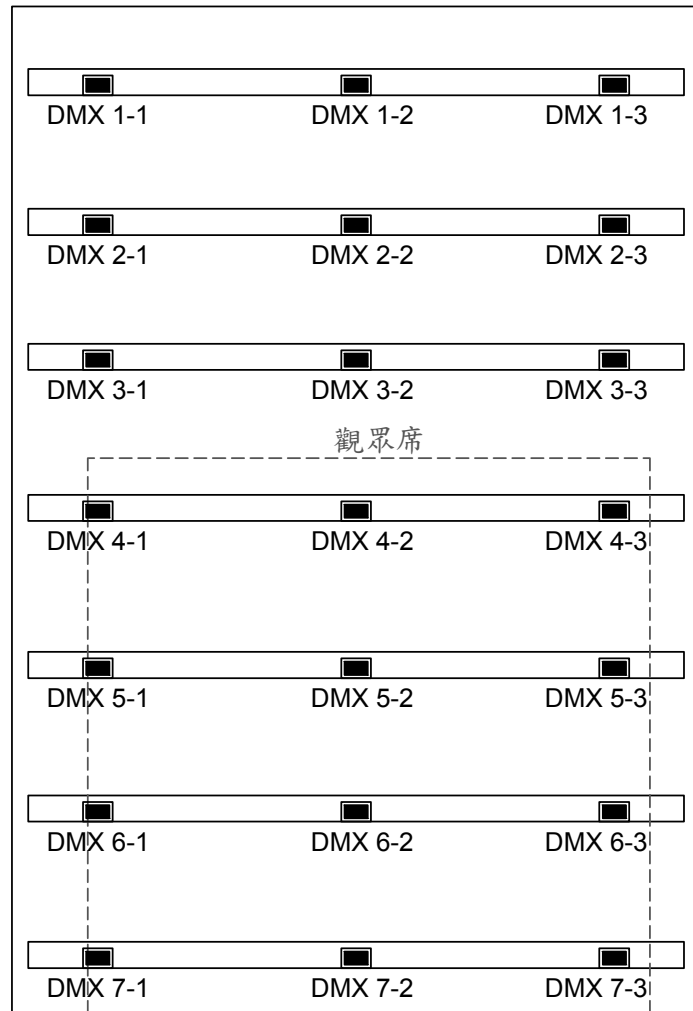
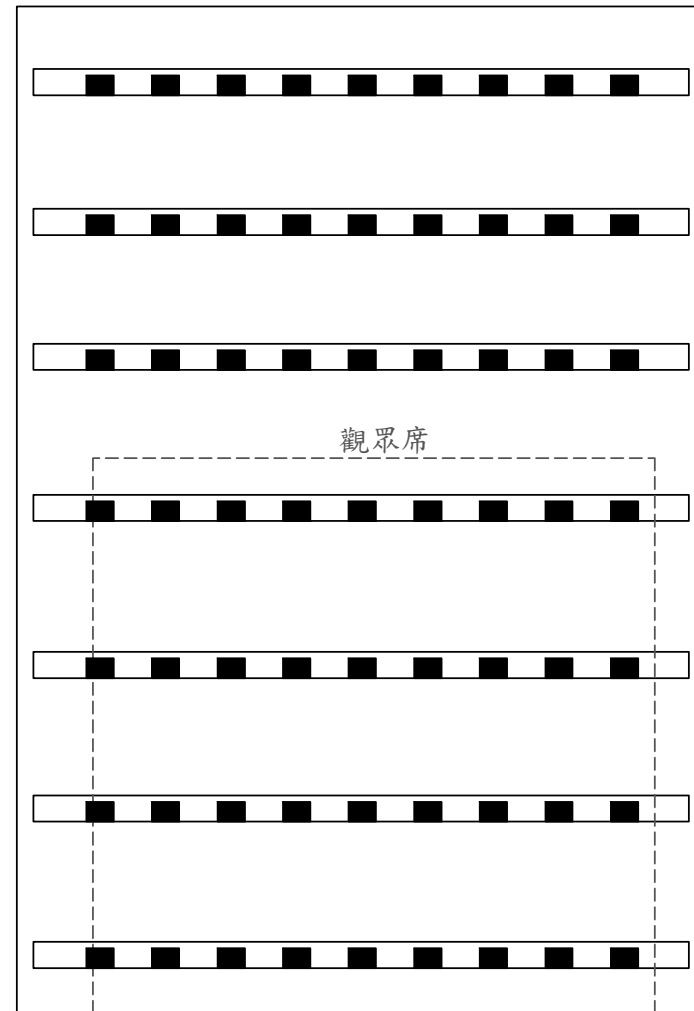

燈桿 1
燈桿 2
燈桿 3
燈桿 4
燈桿 5
燈桿 6
燈桿 7



燈桿 1
20A
燈桿 2
20A
燈桿 3
20A
燈桿 4
20A
燈桿 5
20A
燈桿 6
20A
燈桿 7
20A

圖 (五) 臺音館視聽室_燈光訊號及迴路位置圖 (單位：公分)
Figure(5) Lecture Room_Lighting Circuit Information (Unit: cm)

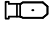
KEY

-  ACME XA-400 SPOT
-  ETC LED S2 Lustr CYC (模式: Direct)
-  TMM LED PAR
-  ETC LED S2 Lustr 36 (模式: Direct)
-  Channel No.

燈具Address No. 對照表

Chan. No.	燈型	Address No.	Chan. No.	燈型	Address No.
21	ETC CYC	20 - 29	41	ETC LED 36	330 - 339
22	ETC CYC	30 - 39	42	ETC LED 36	340 - 349
23	ETC CYC	40 - 49	43	ETC LED 36	350 - 359
24	ETC CYC	50 - 59	44	ETC LED 36	360 - 369
25	ETC CYC	60 - 69	45	ETC LED 36	370 - 379
26	ETC CYC	70 - 79	46	ETC LED 36	380 - 389
27	ETC CYC	80 - 89	51	LED PAR	120 - 126
31	ACME SPOT	401 - 419	52	LED PAR	127 - 133
32	ACME SPOT	180 - 198	53	LED PAR	134 - 140
33	ACME SPOT	200 - 218	54	LED PAR	141 - 147
34	ACME SPOT	220 - 238	55	LED PAR	155 - 161
35	ACME SPOT	240 - 258	61	ACME SPOT	421 - 439
36	ACME SPOT	260 - 278	62	ACME SPOT	461 - 479
37	ACME SPOT	280 - 298	63	ACME SPOT	441 - 459
38	ACME SPOT	300 - 318	64	ACME SPOT	481 - 499

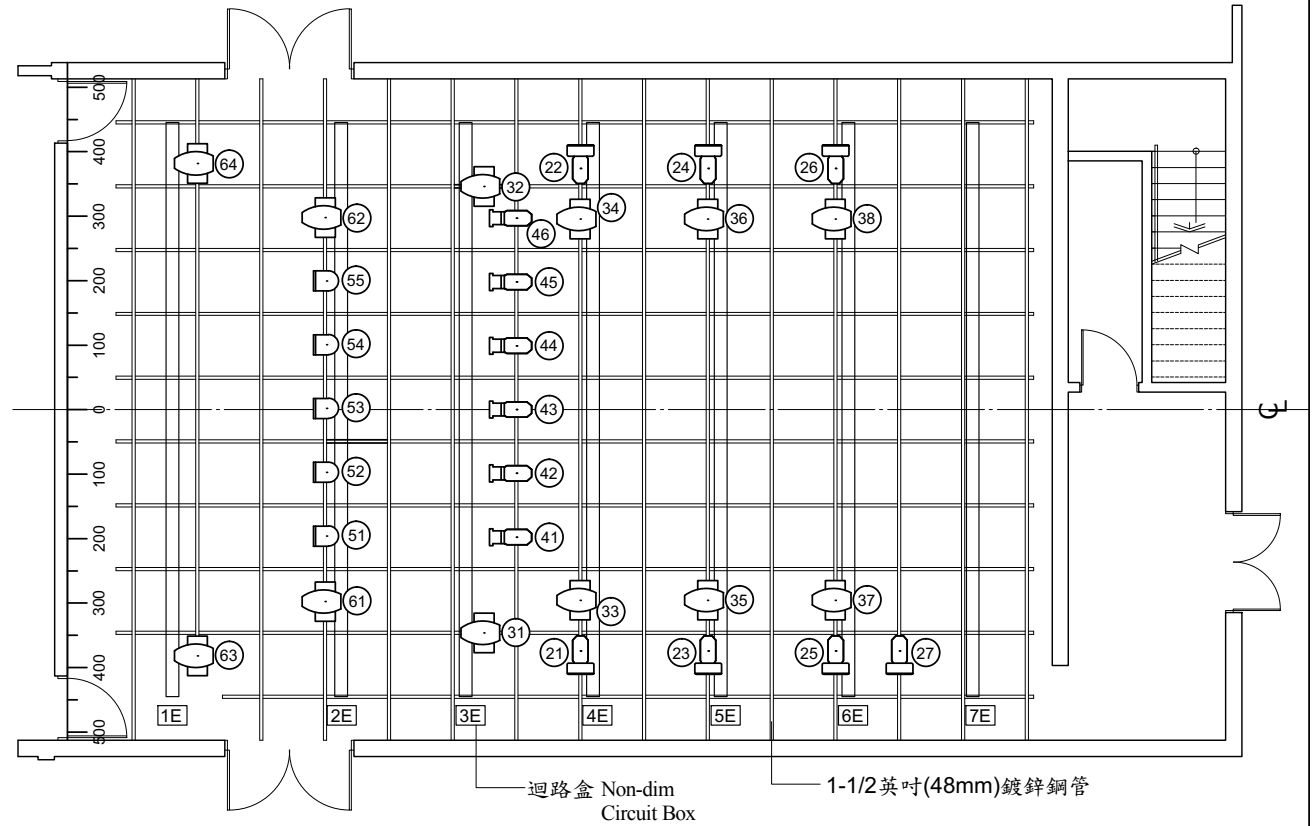

NOTE

本圖基本配置燈具位置固定，
不開放移動。

NOTE: Lighting Fixtures are immovable.

臺音館視聽室
燈具配置圖

單位：公分

圖 (六) 臺音館視聽室_燈具配置圖 (單位：公分)

Figure(6) Lecture Room_Light Plot (Unit: cm)

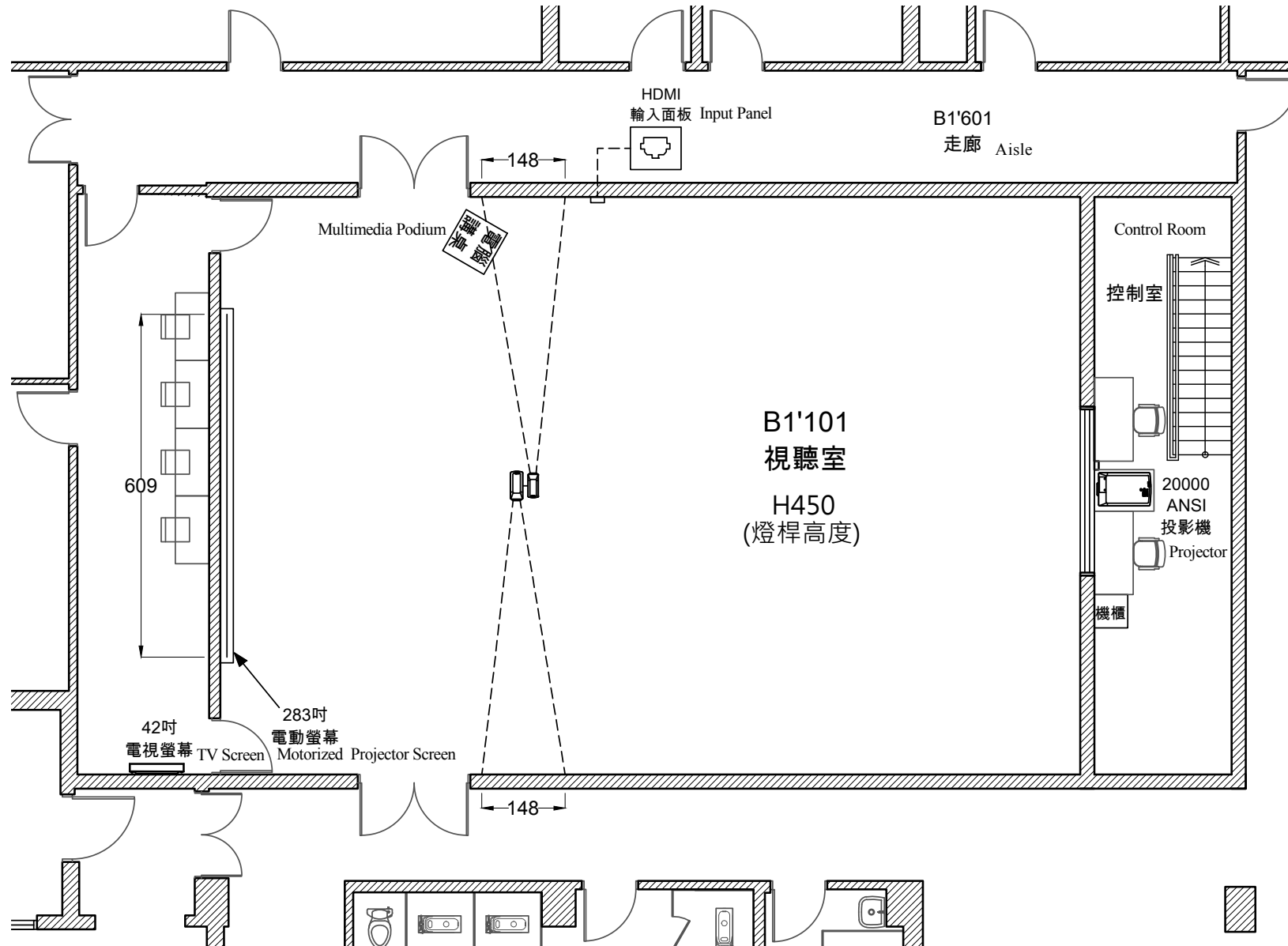

圖 (七) 臺音館視聽室__視訊配置圖 (單位：公分)
Figure(7) Lecture Room__Video Plan (Unit: cm)